



INSTRUCTION BULLETIN

No. 340198
Machine: ATLV 4300
Published: 10-98/00
System: OPTIONS

NOTE: DO NOT DISCARD the Parts List from the Instruction Bulletin. Place the Parts List in the appropriate place in your machine manual for future reference. Retaining the Parts List will make it easier to reorder individual parts and will save you the cost of ordering an entire kit.

NOTE: Numbers in parenthesis () are reference numbers for parts listed in Bill of Materials.

Installation instructions for kit number 367558

SYNOPSIS / PROBLEM:

This kit contains the parts needed to install a fence line kit on the model ATLV 4300.
Please follow step-by-step instructions.

SPECIAL TOOLS / CONSIDERATIONS: Hand drill

(Estimated time to complete: 2 hours)

INSTALLATION:

(Refer to FIG. 1 thru 7)

FOR SAFETY: Before leaving or servicing machine, stop on level surface and set parking brake. Then turn off machine and remove key.

1. Use the dimensions in Fig. 2 to mark and drill the mount holes for the fence tool bracket (1). Use the three hex screws (2), washers (4), and nuts (3) to mount the tool bracket (1).
(Refer to FIG. 1 and 2)
2. Install the four rubber bumpers (5) into the mount holes in the fence tool bracket (1).
(Refer to FIG. 1)
3. Use the dimensions in Fig. 4 to mark and drill the mount holes for the hanger bracket (13). Use the two thread rolling screws (14) to mount the hanger bracket (13).
(Refer to FIG. 3 and 4)
4. Remove the worm drive clamp, lower vacuum tube, and existing connector ring from the lower end of the vacuum tube assembly. Discard the existing connector ring. (Refer to FIG. 7)
5. Position the lower vacuum tube onto the new fence tool bracket (1). Use the rubber tie-down strap (9) to secure the lower vacuum tube to the bracket (1). (Refer to FIG. 2 and 7)
6. Use a razor knife and wire cutter to remove 3 inches from the end of the vacuum hose.
(Refer to FIG. 7)
7. Install the new plastic split ring (6) into the shortened end of the vacuum hose. Reinstall the worm drive clamp. (Refer to FIG. 5 and 7)
8. Install the new fence head (7) into the new plastic split ring (6). (Refer to FIG. 5 and 6)

9. Use the new hose clamp (8) to secure the fence head (7) to the split ring (6).
(Refer to FIG. 5, 6, and 7)
10. Hang the fence head (7) and vacuum hose onto the new hanger bracket (13) when not in use. (Refer to FIG. 3 and 6)

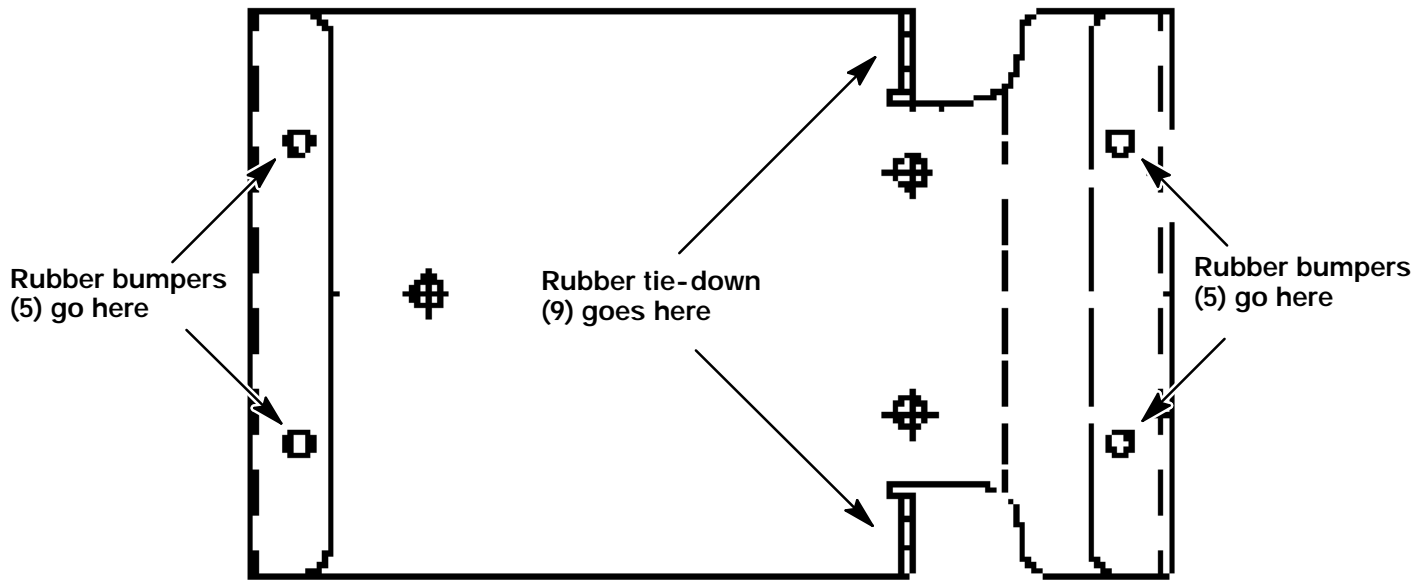

FIG. 1 - Fence Tool Bracket (1)

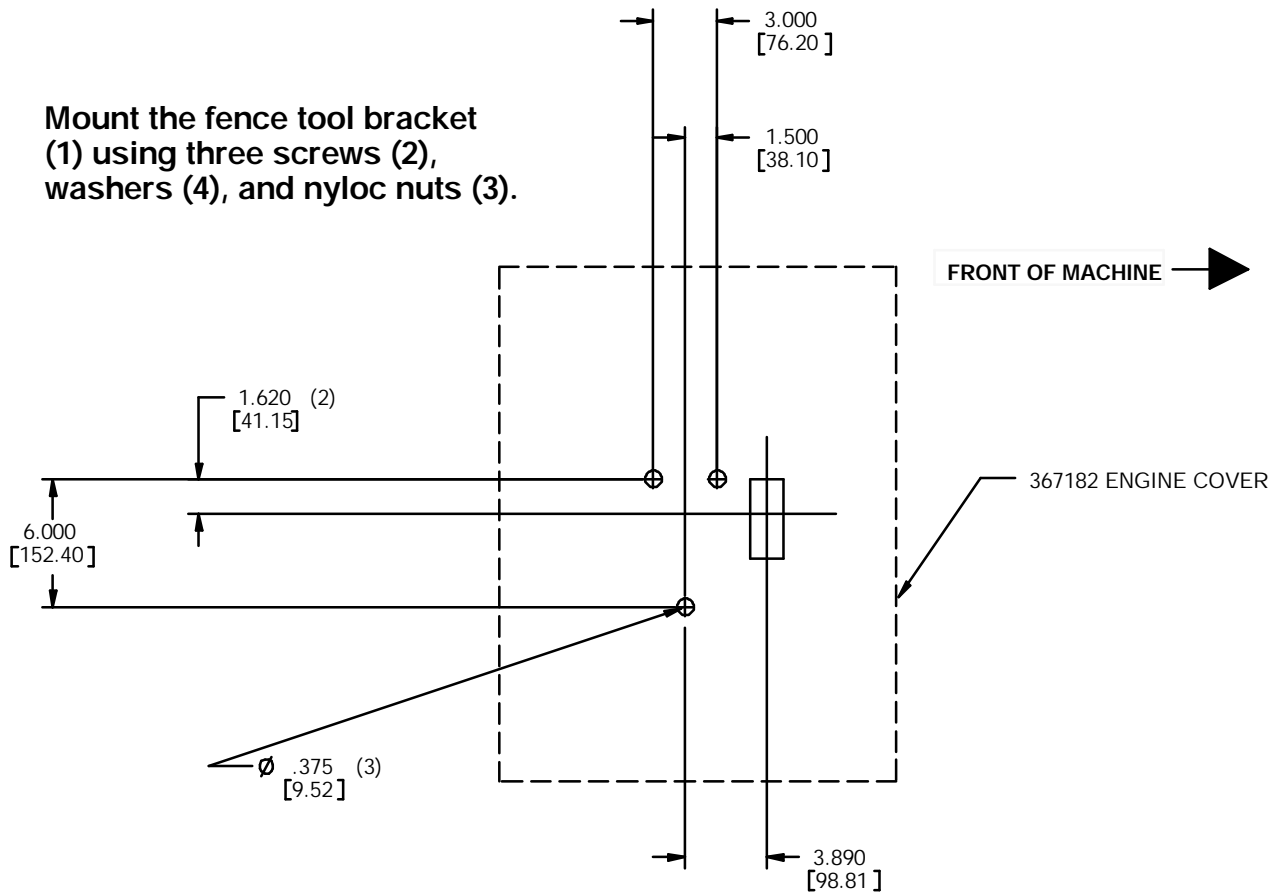

FIG. 2 - Mount Hole Location For Fence Tool Bracket (1)

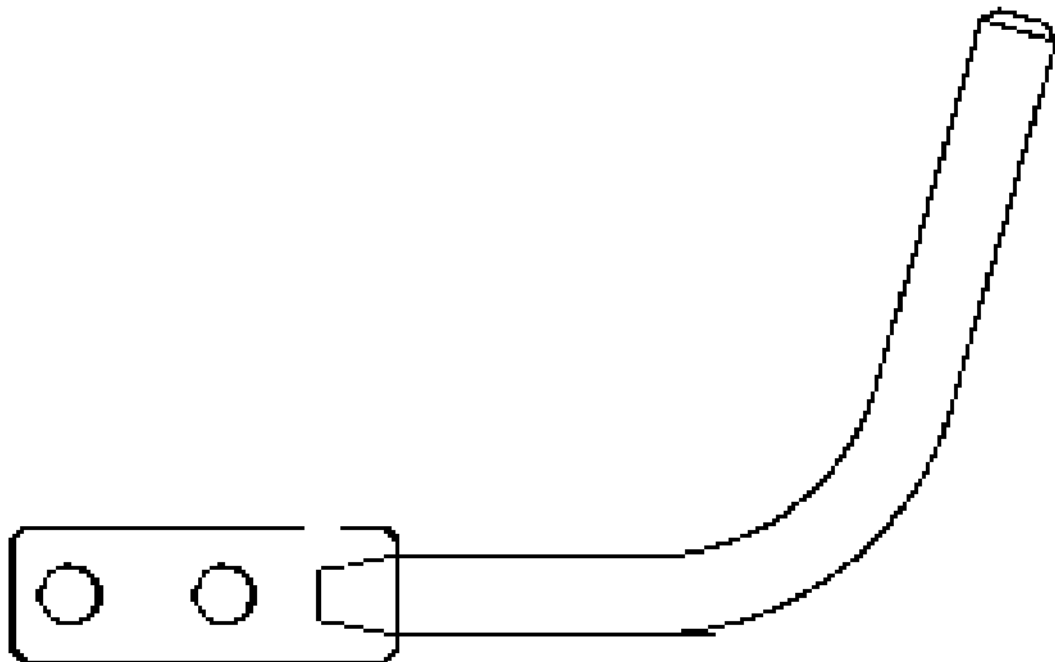

FIG. 3 - Hanger Bracket (13)

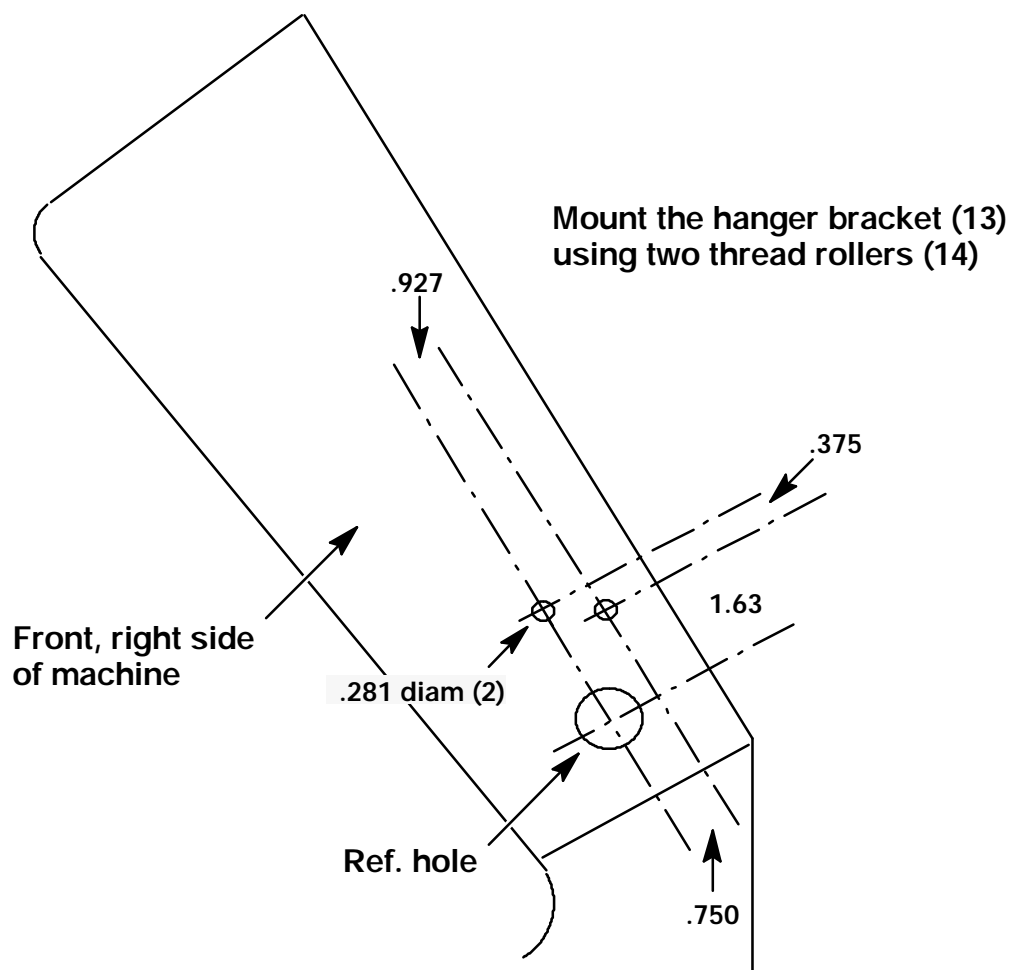

FIG. 4 - Mount Hole Location Tool Hanger Bracket (13)

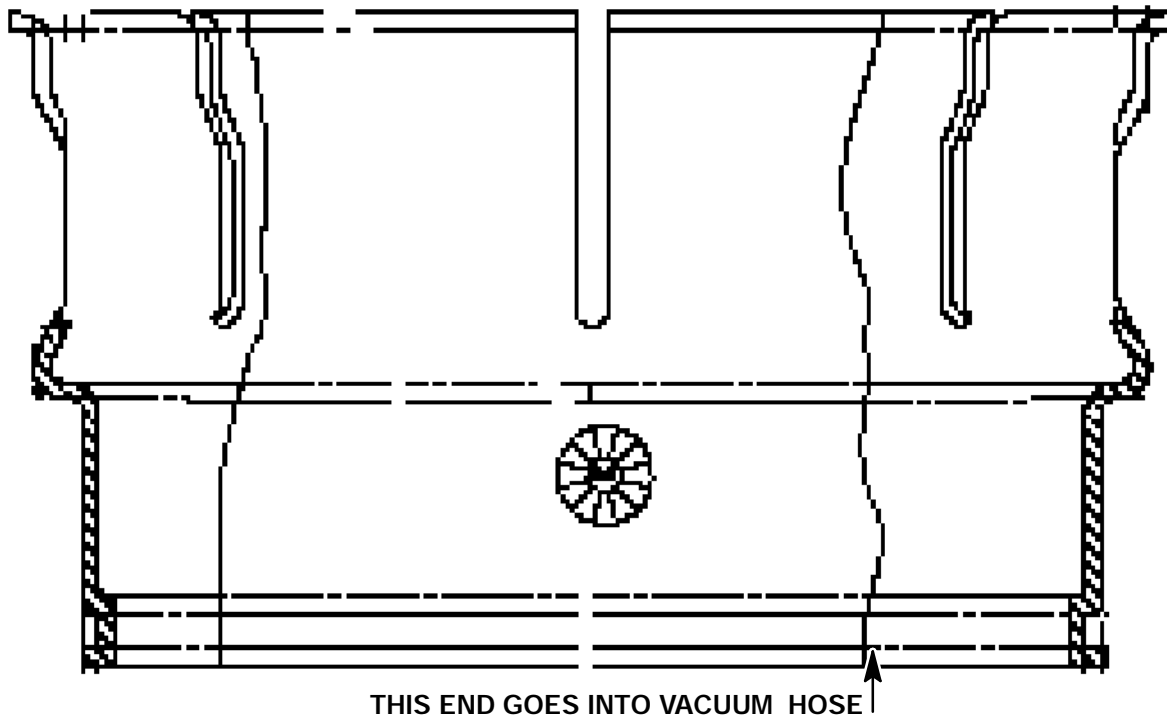

FIG. 5 - Plastic Split Ring (6)

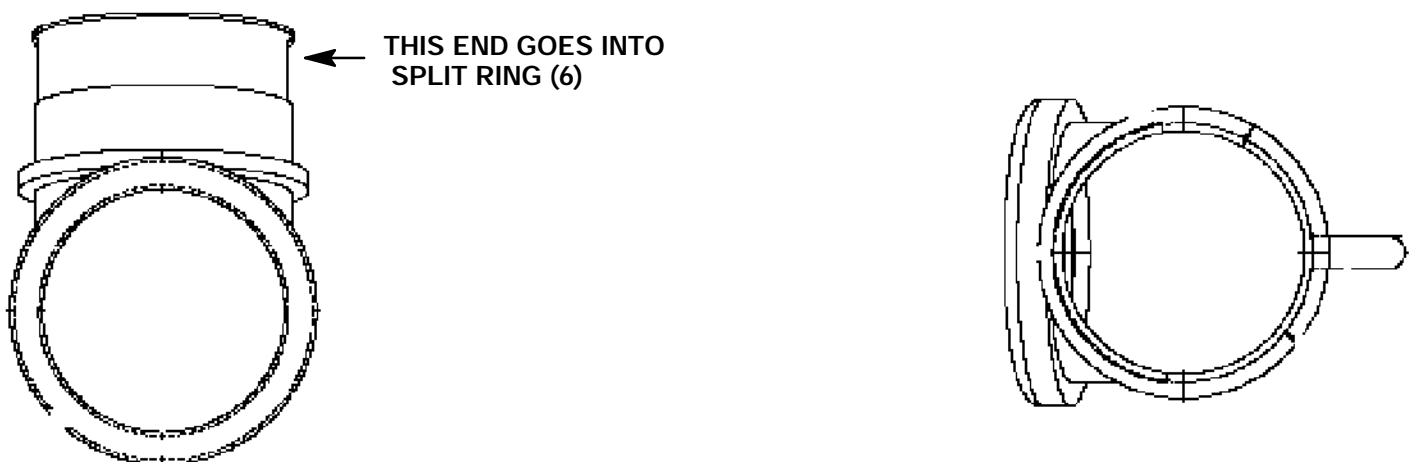

FIG. 6 - Fence Head (7)

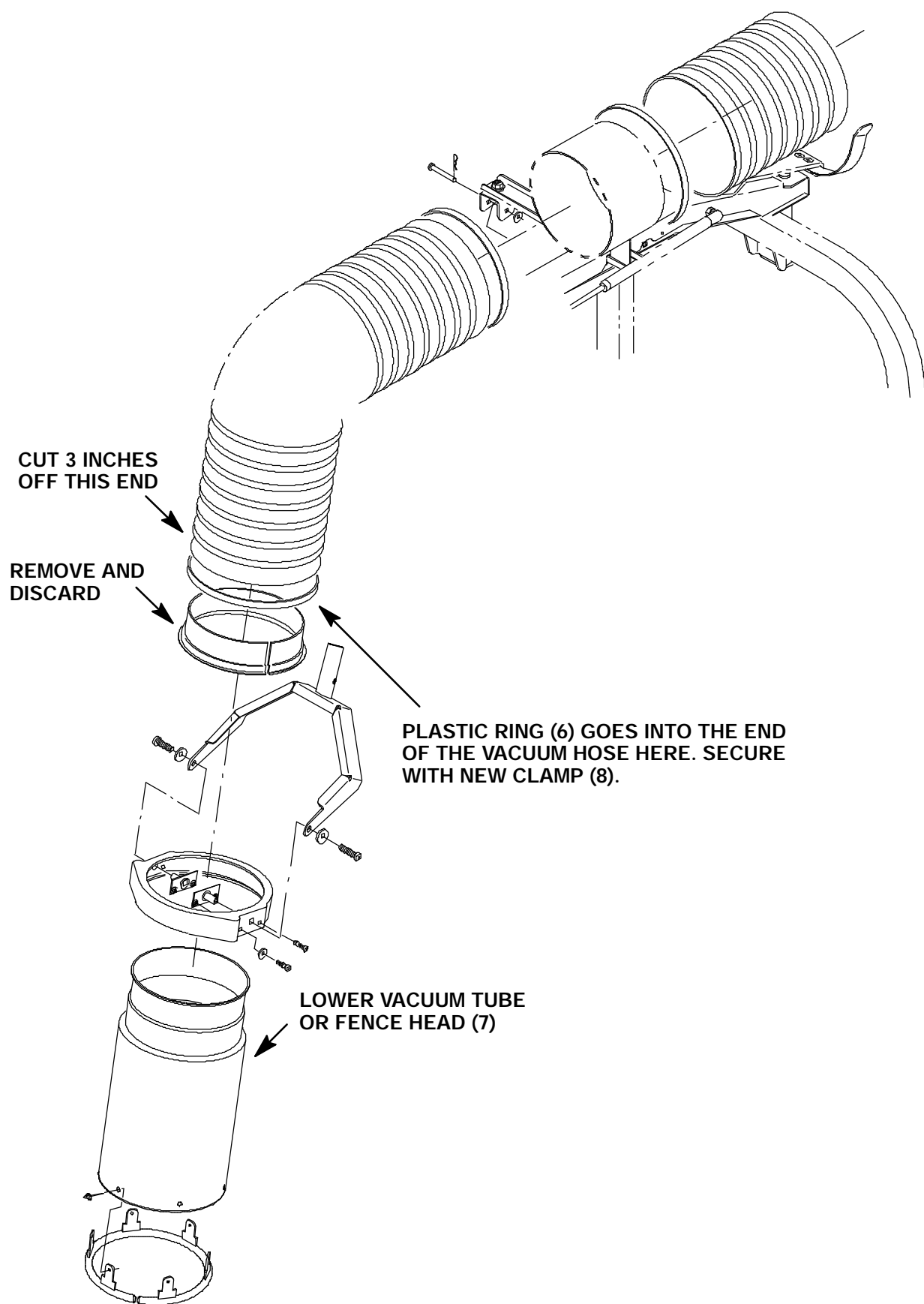

FIG. 7 - Vacuum Hose Assembly

BILL OF MATERIALS FOR FENCE LINE KIT 367558

Ref.	TENNANT Part No.	Description	Qty.
1	367975	Fence tool bracket	1
2	09740	M8 hex screw, 20mm	3
3	08709	M8 hex nut	3
4	01685	.31 inch flat washer	3
5	51787	Rubber bumper	4
6	367973	Plastic split ring	1
7	367314	Fence head	1
8	367972	Hose clamp	1
9	33671	Rubber tie-down strap	1
10	09740	M8 hex screw, 20mm	2
11	08709	M8 hex nut	2
12	01685	.31 inch flat washer	4
13	368044	Hanger bracket	1
14	76099	M8 hex screw, 25mm, thread roller	2

TENNANT COMPANY
P. O. Box 1452
Minneapolis, MN 55440-1452